

Maintenance of Redington Gear type reel

This reel is designed for freshwater use. Used in this environment, the reel requires minimal maintenance.

1. Rinse the reel thoroughly in freshwater to remove sediments; if applicable.
2. Dry all reel surfaces.
3. Apply a thin layer of grease to all gear surfaces.
4. Lubricate the shaft (21) with grease.
5. Apply a small amount of oil to one way bearing (16), located inside the spool.
6. Lubricate clicker (18) and click plate (23) with oil.
7. Over lubrication is detrimental to the performance of this reel and is not recommended.

REDINGTON

TACKLE CO.

GD SERIES

**FOR LINE AND BACKING CAPACITIES, PLEASE SEE OUR ONLINE
CATALOG ARCHIVE.**

REDINGTON GD SERIES

PARTS ARE NOT AVAILABLE FOR THE GD.
PLEASE SEND YOUR REEL IN FOR REPAIR.

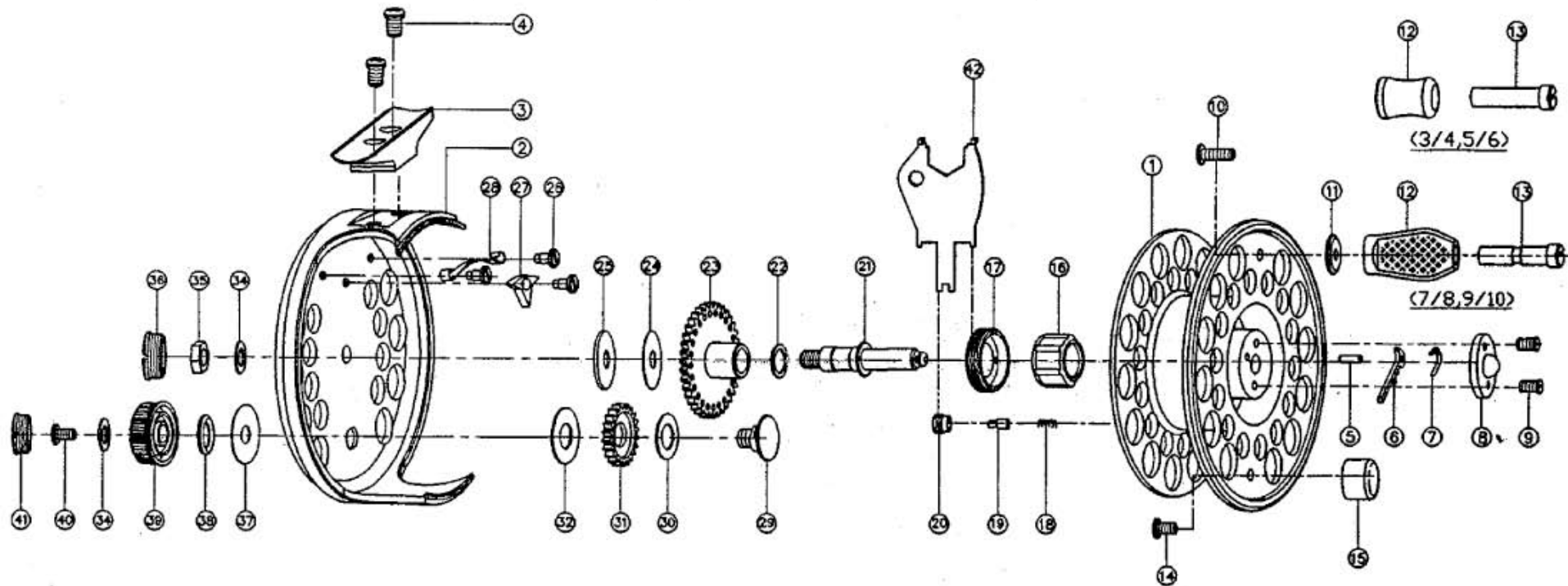

NO.	PART NAME	NO.	PART NAME	NO.	PART NAME	NO.	PART NAME	NO.	PART NAME	NO.	PART NAME	NO.	PART NAME
1	SPOOL	7	PUSH HEAD SPRING	13	HANDLE RIVET	19	SPOOL CLICK PIN	25	GUIDE WASHER	31	DRAG GEAR	37	DRAG KNOB WASHER
2	HOUSING	8	PUSH HEAD COVER	14	BALANCE SCREW	20	SPOOL CLICK NUT	26	CLICK SCREW	32	DRAG WASHER II	38	O-RING
3	REEL FOOT	9	PUSH HEAD COVER SCREW	15	HANDLE BALANCE	21	MAIN SHAFT	27	CLICK PAWL			39	DRAG KNOB
4	REEL FOOT SCREW	10	HANDLE SCREW	16	ONE WAY BEARING	22	DISK PLATE I	28	DISK CLICK SPRING	34	GUIDE WASHER	40	DRAG SHAFT SCREW
5	PUSH HEAD PIN	11	HANDLE COLLAR	17	ONE WAY COVER	23	DISK GEAR	29	DRAG SHAFT	35	MAIN SHAFT NUT	41	DRAG KNOB CAP
6	PUSH HEAD	12	HANDLE KNOB	18	SPOOL CLICK SPRING	24	ADJUSTMENT WASHER	30	DRAG WASHER I	36	HOUSING CAP	42	KEY*